

Instruction Manual

ALL-IN-ONE BOXING SET™

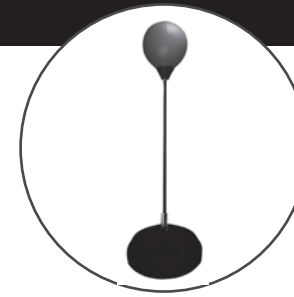

Read through this entire instruction manual BEFORE using **All-in-one Boxing Set**. We're dedicated to bringing you well-designed products that make living fun and easy. We stand behind all our products and warrant this to be free from defects in workmanship and materials.

For service claims or questions please consult our website **ProtocolDesign.com**.

WARNINGS:

- Make sure the set is fully secure before hitting the ball.
- Only use the set in areas that are clear of obstacles, objects, and other people. Do not use near anything valuable in case the ball or set comes loose.
- Be aware that any exercise involving physical contact may result in injury.

INSTALLATION:

1. Inflate the punching bag using the inflation pump and pump needle.

IMPORTANT: This punching bag is constructed with an inner bladder beneath the surface. When inflating the punching bag, use care when inserting the needle. Wet it first and then insert it GENTLY into the air hole taking care not to puncture the inner bladder.

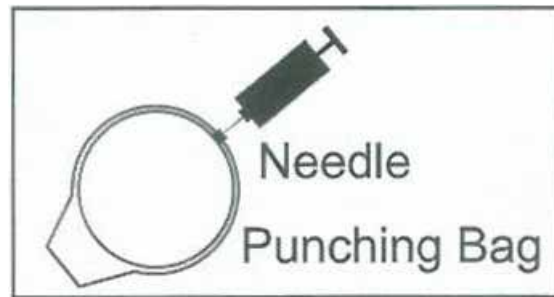

PROTOCOL

INSTALLATION:

2. Assemble the set as shown in the diagram to the right.
3. Remove cap and fill the base with sand or water. Replace the cap.

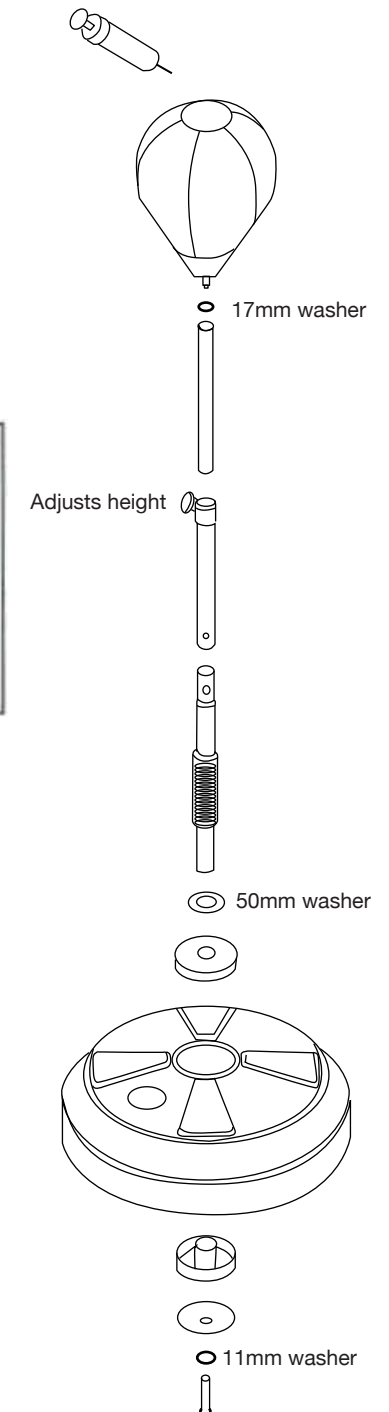

PROTOCOL